

Safety 637-647

Back-Up Alarms	638
Conspicuity Tape	638-640
Dock Bumpers	640-641
Extruded	640
Laminated	640
Fiber-Reinforced	641
Fire Extinguishers	642
Flags & Banners	643-644
Banners	643
Flags	643-644
Placards	644-646
Placard Holders	644
Flip Placards	645
Accessories	646
Roadside Hazards	647
Tire Chains	647
Wheel Chocks	648

Security 648-660

Door Seals	648
Gladhand Locks	648
Kingpin Locks	649
Twistlocks	650-660

Accessories 661-682

Coil Racks	661
Decals	662-663
Document Holders	663-665
Fenders	665-667
Log Books	668
Mirrors	668
Mudflaps	669-678
Brackets	673-678
Tire Carriers	679
Vents	679-681
Wiper Blades	682

Back-Up Alarms

BAC-A-LARM

	Type
PRC230	12 VDC
PRC250	12-24 VDC

Compact size & universal mounting bracket; self grounding with stud terminal connections, sealed in epoxy against dust, moisture & vibration; 0.2 Amps



Conspicuity Tape

Diamond Grade™

Marking Series 963 & 983

	Color	Width	Length	Unit	Count	Additional
MMM983-71	Yellow	2 in.	150 ft.	Roll	1	
MMM983-72-2	Red	2 in.	150 ft.	Roll	1	
MMM983-10-2X18	White	2 in.	18 in.	Strips	100	
MMM983-10-2	White	2 in.	150 ft.	Roll	1	
MMM983-326-2	Red/White (6/6 in.)	2 in.	150 ft.	Roll	1	
MMM963-32-2	Red/White (11/7 in.)	2 in.	150 ft.	Roll	1	Flexible Prismatic
MMM983-32-2X18	Red/White (11/7 in.)	2 in.	18 in.	Strips	100	
MMM983-32-2	Red/White (11/7 in.)	2 in.	150 ft.	Roll	1	
MMM983-32-2X18KC	Red/White (11/7 in.)	2 in.	150 ft.	Kiss-Cut Roll	1	Cut at 18.00 in.



(MMM983-71)



(MMM983-72-2)



(MMM983-10-2X18)



(MMM983-10-2)



(MMM983-326-2/
MMM983-32-2)



(MMM983-32-2X18/
MMM983-32-2X18KC)

963 - 5 year warranty, non-prorated
983 - 7 year warranty, non-prorated

3M

V92 Daybright DOT

	Color	Width	Length	Unit
REF18796	White	2 in.	150 ft.	Roll
REF18806	Red/White (11/7 in.)	2 in.	150 ft.	Roll

Daytime white appearance; highest nighttime reflectivity in the industry; single layer construction; thin & flexible for easy application

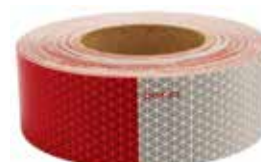

(REF18806)

Orafol

3M

Safety

SFT

ORAFOL



3M Science.
Applied to Life.™

**Sometimes visibility
is a moving target.**

At night, large moving vehicles must be highly visible so other drivers can make quick, accurate decisions. In all types of conditions, the high reflectivity and wide angularity of 3M™ Diamond Grade™ Conspicuity Markings help to ensure superior brightness. These markings are strong, rigid and corrosion-resistant with a high performance adhesive that sticks securely to trucks, trailers and emergency vehicles. Helping drivers see large vehicles helps make roads safer for everyone.

For over 75 years, 3M has been at the forefront of road safety innovation. 3M.com/RoadSafety

Conspicuity Tape

V82 DOT

	Color	Width	Length	Unit
REF18352	Red/White (11/7 in.)	2 in.	18 in.	Strips
REF18686	Red/White (11/7 in.)	2 in.	150 ft.	Roll
REF19160	Red/White (7/11 in.)	2 in.	150 ft.	Roll
REF18347	White	2 in.	12 in.	Strips



(REF18352)



(REF18686)



(REF19160)

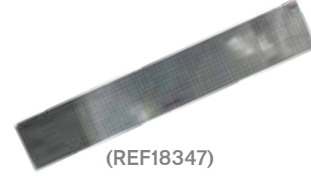

(REF18347)

Highest nighttime reflectivity; exceeds minimum requirements by 200%; single layer construction; thin & flexible for easy application

Orafol

Signal-Stat Economy Tape

Color	Length	Unit	
Red/White	150 ft.	Roll	TRU37



Truck-Lite

Flexible prismatic conspicuity tape; tough, durable film resists cracking & lifting; impact resistant; reflects light at all application angles on the roadway

Dock Bumpers

Extruded

Part Number	Width	Height	Length	Number of Bolt Holes
IMXD-312	3 in.	3 in.	12 in.	2
IMXD-324	3 in.	3 in.	24 in.	4
BUYD324	3 in.	3 in.	24 in.	4
IMXD-412	4 in.	4 in.	12 in.	2
IMXD-424	4 in.	4 in.	24 in.	
IMXD-472	4 in.	4 in.	72 in.	



Undrilled



Drilled

Laminated

	Width	Height	Length	Mount
IMXGT-2109	2-3/4 in.	3 in.	6 in.	Stud
IMXGT-2107	3-1/4 in.	2-3/4 in.	6-1/8 in.	Stud
IMXGT-2101	4 in.	4 in.	6 in.	Bolt-On
FRUXUB7259	4 in.	-	15 in.	Bolt-On



Bolt-On



Stud

Dock Bumpers

Fiber-Reinforced

Part Number	Width	Height	Length	Number of Bolt Holes	Bolt Center	Cross Reference
GDA42800101	2 in.	3 in.	10 in.		7 in.	
IMXGT-2042	2-3/8 in.	2 in.	7-3/8 in.	2	4-5/8 in.	
IMXGT-2312	2-3/8 in.	3-1/4 in.	6 in.	2	2-5/8 in.	
IMXGT-2041	2-1/2 in.	2 in.	16 in.	3	6-1/2 in.	
BUYB52641	2-1/2 in.	3-1/4 in.	6-3/4 in.		3-3/4 in.	Great Dane# 035-25182
IMXGT-2345	2-5/8 in.	3-1/4 in.	6 in.	2	3-1/2 in.	
IMXGT-UTM214	2-5/8 in.	3-1/2 in.	4-5/8 in.	2		Utility# 03-1250-214
IMXGT-2044	2-3/4 in.	3 in.	6 in.	2	2-5/8 in.	
DBR-GD02	2-3/4 in.	3-3/8 in.	5-5/8 in.	2	2-1/2 in.	Great Dane# 41700303
DBR-CC01	2-7/8 in.	3-1/4 in.	6 in.	2	2-1/2 in.	
IMXGT-2006	3 in.	3-1/2 in.	6 in.	2	3 in.	
IMXGT-2038	3 in.	4-1/4 in.	6 in.	2	1-3/4 in.	
BUF4502-1276	3 in.	6 in.	3 in.			
BUYB5500	3 in.	6 in.	3-1/2 in.			
FRUXCF9657-1	3-1/8 in.	3-1/4 in.	3-7/8 in.	2	2 in.	
WAB21400380	3-1/2 in.	3-1/2 in.	5-5/8 in.	2	3-1/2 in.	
DBR-UT01	3-5/8 in.	3-1/2 in.	6-1/8 in.	2	3-1/2 in.	Utility# JK3915
IMXGT-UTM006	3-5/8 in.	3-1/2 in.	6-1/8 in.	2	3-1/2 in.	
JKG3781	3-5/8 in.	3-1/2 in.	6-1/8 in.	2	3-1/2 in.	
IMXGT-UTM259	3-5/8 in.	4 in.	6-1/8 in.	2	3-1/2 in.	Utility# 03-1250-259
IMXGT-UTM172	3-5/8 in.	4-1/2 in.	6-1/8 in.	2	3-1/2 in.	Utility# 03-1250-0-172
JKG3630	3-5/8 in.	4-1/2 in.	6-1/8 in.	2		
IMXGT-2027	3-3/4 in.	4-1/2 in.	5-1/8 in.	2	3-1/2 in.	
IMXGT-2043	4 in.	3-1/4 in.	6 in.	2	2-1/2 in.	BBTP4800-0007
TSCPBA-687	4-3/8 in.	2-1/2 in.	12-1/4 in.	3		
IMXGT-2036	5-1/4 in.	3-5/8 in.	8 in.	4	5-1/2 in.	
IMXGT-2045	5-1/2 in.	3-5/8 in.	7-5/8 in.	4	3 in.	
IMXGT-2046	6 in.	8 in.	3 in.	4	3-1/8 in.	



(IMXGT-2042)



(IMXGT-2041)



(IMXGT-UTM172)



(IMXGT-2043)



(IMXGT-2036)



(IMXGT-2046)

More Information

www.MyAuroraPlus.com

Need more information on a particular trailer? Log into www.MyAuroraPlus.com for Aurora's Graphical Bill of Material (GBOM). Easily point and click through visual elements of a trailer to drill down to an individual trailer part.



Safety

SFT



Fire Extinguishers

ABC Automotive

	Weight	Bracket	Fire Class
WLK440162	2-1/2 lbs.	Plastic Bracket	ABC
WLK440161	2-3/4 lbs.	Steel Strap	BC
WLK466425	5 lbs.	Bracket	ABC
SFP13415D	2-1/2 lbs.	Steel Strap	BC



(WLK440162) (WLK440161) (WLK466425) (SFP13415D)

Fire Extinguisher Inside DEC1-5



Fire Extinguisher Inside LABMPDFL1000



Bright, bold lettering is printed with fade-resistant UV inks on exterior grade vinyl with permanent adhesive backing; Measures 1-3/4 in. x 10 in.

Mounting Bracket WLK420118



For 2-1/2 to 2-3/4 lbs. fire extinguishers; bracket only

More Information

Fire Extinguisher Classes

Class A fire consists of ordinary combustibles or fibrous materials such as wood, paper, cloth, rubber, and some plastics. To extinguish, cool the material below its ignition temperature and soak the fibers to prevent re-ignition. Extinguishers appropriate for Class A fires include water, foam, loaded stream, or multipurpose dry chemical.

Class B fire is fueled by flammable or combustible liquids, gases, grease or similar material such as gasoline, kerosene, paint thinners and propane. It can be extinguished by removing the oxygen, preventing vapors from reaching an ignition source or otherwise inhibiting the chain reaction. Extinguishers appropriate for Class B fires include Halon, HCF 125 (clean agents), carbon dioxide, dry chemicals, foam, or loaded stream.

Class C fires involve energized electrical equipment like appliances, panel boxes, and power tools. The extinguisher used must not be capable of conducting electrical currents. If you can first remove the power, you can extinguish the fire like any other fire in Class A, B, or D. Extinguishers appropriate for Class C fires include Halon, carbon dioxide, or multipurpose dry chemical.

Class D fires involve certain combustible metals such as magnesium, titanium, potassium, and sodium. They react violently to water and certain other chemicals. Combustible metals must be extinguished using dry powders specifically designed for use on that metal.

Safety

SFT

Flags & Banners

Vinyl Banner

	Height	Length	Text
MCAAV102	18 in.	84 in.	WIDE LOAD/ OVERSIZE LOAD
MCAAV104	18 in.	84 in.	OVERSIZE LOAD
MCACV102	12 in.	72 in.	WIDE LOAD/ OVERSIZE LOAD



(MCAAV102/
MCAAV104)



(MCACV102)

Ms. Carita

Mesh Banner

	Width	Length	
	84 in.	18 in.	MCAAVM104
	72 in.	12 in.	MCACVM104



Ms. Carita

9 oz. Vinyl-coated polyester & allows up to 30% air flow for less wind resistance; finished top & bottom with edge binding

Vinyl Wide Load Banner MSPWIDELOAD



Ms. Carita

Oversize load banner; with four grommets & four 42 in. ropes; 7 in. X 18 in.

Mesh Oversize Load Banner JJK678-R



J.J. Keller

Vinyl coated 1000 denier polyester mesh fabric; UV stabilized to prevent fading; 12 ft. ropes sewn into top and bottom; 7 ft. x 18 in.

Flag-Mag MCAMF101



Ms. Carita

For attaching flags to machinery & flat steel surfaces; chrome cup magnet has 85 lbs. Of pull on 1/2 in. steel; filled with extra epoxy for heavy-duty use; includes hardware

Staff Flag

	Type	
	Flourescent Red Mesh	ACR49893-13



Ancra

heavy-duty mesh flag with 3/4 in. x 30 in. wooden dowel; 18 in. x 18 in.

Bungee Flag

	Type	
	Orange Mesh	MCAFB300C



Ms. Carita

Built in heavy duty bungee cords and flexible welting; 18 in. x 18 in.

Safety

SFT

J.J. Keller & Associates, Inc.
Since 1952

Flags & Banners

Staff Flag

Type
Red Jersey **MCAFS300C**





Ms Carita

Staffs are 3/4 in. X 30 in. Wood dowels; sewn pockets; 18 in. X 18 in.

Wire Loop Flag

Type
Red Jersey **MCAFW300C**
Flo-Orange Mesh **MCAFW400C**





Ms. Carita

18 in. x 18 in.

Warning Flag

Type
Dowel **MSP18X18FWD**
2 Grommets **MSP18X18FWG**

J.J. Keller

Nylon mesh; 18 in. X 18 in., Red

High-Visibility Warning Flag

Type
Cotton **KIN9122**



Kinedyne

Mounted on a steel wire rod; 18 in. X 18 in.

Placards

Placard Holder

	Color	Type	Back Plate
IMXGT-1100	Aluminum	Full	Yes
IMXGT-1100A	Aluminum	4 Clipped Corners	Yes
IMXGT-1101	White	Full	Yes
JJK3-TPH	Stainless Steel	Full	Yes
JJK4-TPH	Aluminum	Full	No
LAB80-SM-S	Aluminum	Split Frame	Yes
LAB80SMWCC97	White	2 Clipped Corners	Yes
LAB80SMW-S97	White	Split Frame	Yes



Safety

SFT

LABELMASTER

Placards

Flip	Color	Blank	Corrosive 8	Combustible 3	Dangerous	Explosive 1.4	Flammable 3	Flammable Gas 2	Flammable Liquid 3	Inhalation Solid 4	Miscellaneous Hazard 2 & 6	Non-Flammable Gas 2	Oxidizer 5.1	Poison 6	Radioactive 7	Type
IMXGT-1150	Aluminum	X	X	X	X	X	X				X	X	X	X		Full
IMXGT-1150W	White	X	X	X	X	X	X				X	X	X	X		Full
IMXGT-1151	Aluminum	X		X	X	X	X				X	X	X	X		Full
IMXGT-1151W	White	X		X	X	X	X				X	X	X	X		Full
LAB126-CT	Aluminum	X	X	X		X						X				Full
LAB126-CTP	Aluminum	X	X	X		X		X	X		X	X				Full
LAB21-8C	Aluminum	X	X	X			X	X	X	X	X	X	X			Full
LAB81-8FO	Aluminum	X	X	X		X	X				X	X	X	X		Full
LAB81-8SFO	Aluminum	X	X	X		X	X				X	X	X	X		Split
LAB81-8WFO	White	X	X	X		X	X				X	X	X	X		Full
LAB81-8WSFO	White	X	X	X		X	X				X	X	X	X		Split



(IMXGT-1150)



(IMXGT-1150W)



(IMXGT-1151)



(IMXGT-1151W)



(LAB126-CT)



(LAB126-CTP)



(LAB21-8C)



(LAB81-8FO)



(LAB81-8SFO)



(LAB81-8WFO)



(LAB81-8WSFO)

17 Legend Flip Placard

LAB20HM206



- Includes:
- Dangerous
 - Flammable Gas 2
 - Poison 6
 - Non-Flammable Gas 2
 - Corrosive 8
 - Flammable Liquid 3
 - Oxidizer 5.1
 - Organic Peroxide 5.2
 - Explosive 1.4
 - Spontaneously Combustible 4
 - Flammable Solid 4
 - Inhalation 6
 - Dangerous When Wet 4
 - Blasting Agents 1.5D
 - Miscellaneous 9
 - PG III
 - Inhalation 2
 - Blank

Label Master

Placards

Replacement Clip
IMXGT-1111



Includes: (2) Rivets

Spring Clip Arm
JJK13073



J.J. Keller

Material: Stainless Steel

Replacement Clip
LAB81-CLIP



Label Master

Clip is made out of stainless steel for durability and can be used to replace a clip on all Spacemaster and Duo-Flip DOT placarding systems.

Clear Placard Holder Shield
LAB80SM-03



Label Master

Constructed of sturdy .03-mil extruded plastic, this shield helps protect metal, tagboard and rigid vinyl placards from falling or blowing out of placard holders

Placard Bracket
WAB251S0052



Wabash

Placard Bracket
WAB251S0087GALV



Wabash

Material: Galvanized Steel

LabelMaster

Safety

SFT



More Information

Hazardous Materials

Class	Material Type
1	Explosives
2	Gas, Non-Flammable Oxygen, Flammable Gas & Poison Gas
3	Flammable, Combustible
4	Flammable Solid, Spontaneously & Dangerous When Wet

Class	Material Type
5	Oxidizer, Organic Peroxide
6	Poison & Inhalation Hazard
7	Radioactive
8	Corrosive
9	Not Required For Domestic Transportation

Safety

646

800.621.7949

= Key Items

www.AuroraParts.com

Roadside Hazards

Triangle Kit

	Type
JKG1005	Kit
JKG1005-CASE	Case Only

Kit of three triangles in a high-density plastic case; set-up requires no tools; self-contained unit needs no power source; 18-3/4 in. x 5 in. x 4-3/4 in.; Meets DOT standard FMVSS 125



J.J. Keller

Orion® Red Safety Flares

	Time	Type
FUS720	20 min.	Red Flare, No Spike / No Stand
FUS730	30 min.	Red Flare, No Spike / No Stand
FUS2730	30 min.	Red Flare, Spike

Unique, patented PlasTcaps have a non-roll feature, ignite easily & continue to burn in all kinds of weather



Leak Detector SSC3-C



3 Minute Smoke Candle

KING

Safety

SFT

KINEDYNE
The Original Custom Fit

Tire Chains

Grip Link Tire Chain

	Type
KIN15400PK	1 Pair in 1 Pair

V-Bar cross chains; four tensioning cams on the outside; 11 in. x 22-1/2 in.



Kinedyne

Wheel Chocks

Rubber

Part Number	Depth	Height	Length	Weight	Eyebolt	Additional
IMXGT-2048	8 in.	5-3/4 in.	9-1/2 in.	9 lbs.	Yes	
JKG3046	8 in.	6 in.	9 in.	6 lbs.	Yes	
IMXGT-2055	8 in.	6 in.	9-1/2 in.	9 lbs.	Yes	Sharp Steps For Better Grip
IMXGT-2047	7-3/4 in.	5-1/2 in.	9-1/2 in.	7 lbs.	Yes	Non-Skid Bottom
IMXGT-2049				11 lbs.		Moded Handle On Back



(IMXGT-2048)



(JKG3046)



(IMXGT-2055)



(IMXGT-2047)



(IMXGT-2049)

Door Seals

Plastic Trailer Seal JJK003TS



Protects cargo against tampering & theft
Material: High-Density Polyethylene
Color: Red

J.J. Keller

Heavy Duty Metal Seal JJK221



Protects cargo against tampering & theft
Material: Tin-Plated Steel

J.J. Keller

Gladhand Locks

Keyed
Different
Alike #151
MSPGHLOCK
MSPGHLOCKKEYALIKE



Economy IMXGT-7200



Keyed Alike K-611; indestructible plastic body;
stainless steel & zinc plated hardware

Security

SFT

J. J. Keller & Associates, Inc.
Since 1953

Kingpin Locks

Economy

	Type	Key
IMXGT-7201	Steel	
IMXGT-7202-01	Iron	01
IMXGT-7202-02	Iron	02
IMXGT-7202-05	Heavy Duty	05



(IMXGT-7201)



(IMXGT-7202-01/
IMXGT-7202-02)

Replacement Key

IMXGT-7202-01K

IMXGT-7202-02K

IMXGT-7202-05K

	Type	Key
WARTKP-10DPS	Display Pack	
WARTKP-10DPL25014	Keyed Alike	25014



(WARTKP-10)



(WARTKP-10KEYALIKE)

Cast steel & designed for dropped/untethered trailers; conical design gives it light-weight & is wide enough to deflect the fifth wheel plate of a tractor

War-Lok

Accessories

Out of Service Tag JJKED-14-TG



J.J. Keller

Size: 6-1/4 in. x 3-1/2 in.

Application Information Gladhand & Kingpin Locks

Gladhand Locks

This lock acts like a harness around the emergency gladhand which must be removed before the emergency brakes on the trailer are released.

Kingpin Locks

This lock prevents unauthorized hookups to any fifth wheel trailer & simply surrounds the kingpin preventing theft and/or unwanted movement.

Twistlocks

Assemblies

Chassis Type

Type	Chassis Type
Retractable	TWL-TL004
Non-Retractable	TWL-TL001



Replacement Parts

Handle	Pin
TWL-HA001	TWL-PT007
Latch	Spring
TWL-LA002	TWL-HD008

Pro-Fit

Type	Chassis Type
Retractable	TWL-TL005
Non-Retractable	TWL-TL006

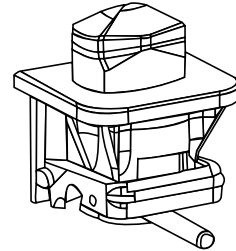

Replacement Parts

Handle	Pin
TWL-HA001	TWL-PT007
TWL-HA023	Spring
	TWL-HD008

Pro-Fit

Pinlock
TWL-PL001

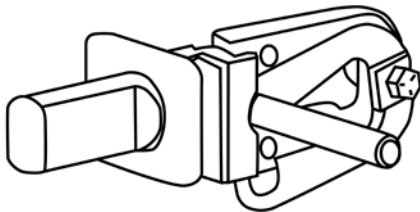

Replacement Parts

Handle	Pin
TWL-HA006	TWL-PP001
Latch	
TWL-LA004	

Pro-Fit

Pinlock

Location	Pinlock
Front Roadside	TWL-PL003
Front Curbside	TWL-PL002

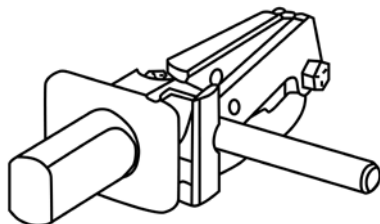

Replacement Parts

Handle	Pin
TWL-HA006	TWL-PP001
Latch	
TWL-LA001	

Pro-Fit

Pinlock

Location	Pinlock
Front Roadside	TWL-PL004
Front Curbside	TWL-PL006

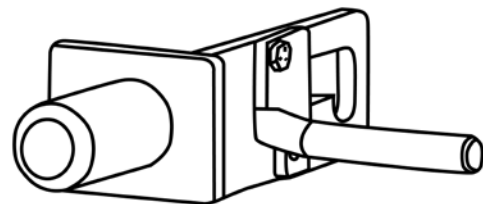

Replacement Parts

Handle	Pin
TWL-HA056	TWL-PP018
Latch	
TWL-LA007	

Pro-Fit

Security

SFT



Security

650

800.621.7949

= Key Items

www.AuroraParts.com



TOCA Industry Technologies, Inc., is proud to be a Aurora Parts business partner.

TOCA has been supplying heavy duty semi-trailer & container chassis original equipment manufacturers, and after-market components for nearly 30 years. Our continually expanding product offering is driven by our customer's needs and are among the largest variety of such parts available from a single supplier.

Examples of a few product types below.



Crank Handles Available In

- Horizontal or Vertical
- Several Model to choose from

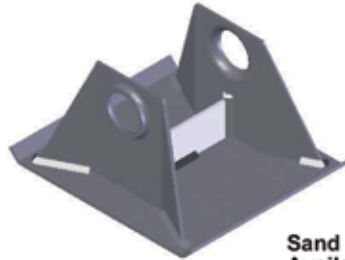

Sand Shoes & Axles Available In

- High or Low profile
- Tubular or Solid
- Several Model to choose from



Adjustable Braces Available In

- Standard or Heavy Duty
- Several Model to choose from



Cross Shaft Available In

- One Piece or Adjustable
- Several Model to choose from



Brace Ears Available In

- Several Model to choose from

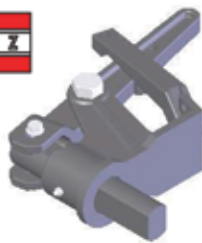

Front Pinlock Assemblies Available In

- Handed or Non-Handed versions
- Several Model to choose from

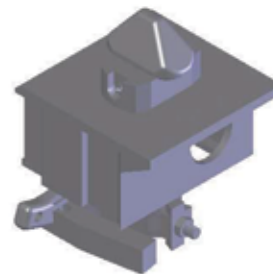

Twist Lock Assemblies Available In

- Retractable or Non-Retractable versions
- Handed or Non-Handed versions
- Several Model to choose from

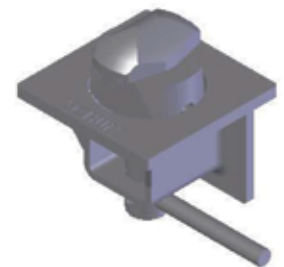

Twistlocks

Assemblies

Pinlock

Location	Part Number
Front Roadside	TWL-PL016
Front Curbside	TWL-PL017

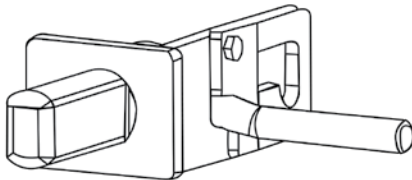

Replacement Parts

Part Name	Part Number
Handle	Pin
TWL-HA056	TWL-PP024
Latch	
TWL-LA007	

Handles

TWL-HA001

Pro-Fit

Material: Steel with Zinc Plate
Fits: TWL-TL001

TWL-HA002

Pro-Fit

Material: Steel
Fits: TWL-TL074

TWL-HA003

Pro-Fit

Material: Steel with Zinc Plate
Fits: TWL-TL008, TWL-TL011

TWL-HA004

Pro-Fit

Material: Hot rolled steel with primer finish

Security

SFT



Twistlocks

Handles

TWL-HA006

Material: Steel with Zinc Plate
Fits: TWL-PL001

TWL-HA009

Material: Hot Rolled Steel with Primer Finish

TWL-HA010

Material: Steel
Fits: TWL-PT022, TWL-PT023

Westlake Style Handle

Type	Part Number
Left Hand	TWL-HA011
Right Hand	TWL-HA012

Material: Hot Rolled Steel

TWL-HA013

Material: Steel
Fits: TWL-PT010

Location	Part Number
Left	TWL-HA018
Right	TWL-HA016

Material: Steel
Fits: TWL-PT052, TWL-PT012

Location	Part Number
Left	TWL-HA025
Right	TWL-HA019

Material: Steel with Zinc Plate
Fits: TWL-PT067

Location	Part Number
Left	TWL-HA021
Right	TWL-HA157

Material: Steel
Fits: TWL-PT012

Security

SFT



Twistlocks

Handles

TWL-HA022

12.00 in.

1-1/4 in.

Pro-Fit

Material: Hot rolled steel with primer finish
Fits: TWL-PL008, TWL-PL018

TWL-HA023

2-13/16 in.

3-1/32 in.

1-3/23 in.

Pro-Fit

Material: Steel with Zinc Plated
Fits: TWL-TL014, TWL-TL055

TWL-HA027

6.00 in.

9/16 in.

Pro-Fit

Material: Steel
Fits: TWL-PL019, TWL-PL020

TWL-HA028
TWL-HA040

Location
Left
Right

4-13/32 in.

3-21/32 in.

5-7/8 in.

Pro-Fit

Material: Steel
Fits: TWL-PT013, TWL-PT103

TWL-HA051

5/8 in.

2-1/8 in.

9 in.

Pro-Fit

Material: Steel
Fits: TWL-PP019, TWL-PP020

TWL-HA156

2-27/32 in.

1-27/32 in.

1-3/32 in.

Pro-Fit

Material: Steel with Zinc Plated
Fits: TWL-TL062, TWL-TL063

Latches

Safety
TWL-LA001

11/16 in.

4-13/16 in.

Pro-Fit

Material: Steel with Zinc Plate
Fits: TWL-PL002, TWL-PL003

Safety
TWL-LA002

4-5/32 in.

4-7/8 in.

Pro-Fit

Material: Steel with Primer Finish
Fits: TWL-TL001, TWL-TL004

Security

SFT



Twistlocks

Latches

**Assembly
TWL-LA003**

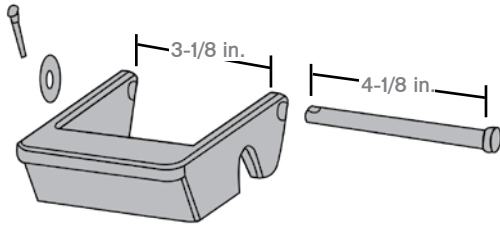

Pro-Fit

Material: Steel
Fits: TWL-PT018

**Safety
TWL-LA004**

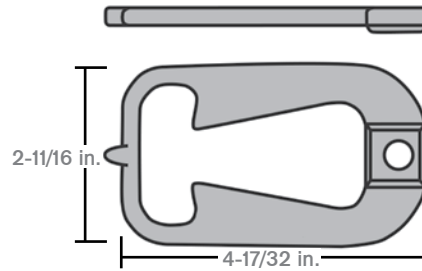

Pro-Fit

Material: Steel with Primer Finish
Fits: TWL-PL001

TWL-LA005

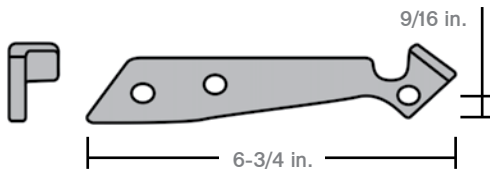

Pro-Fit

Material: Steel with Zinc Plate

Lock

TWL-LA006

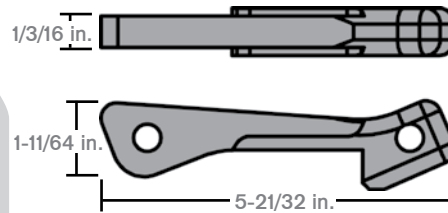

Pro-Fit

Material: Steel
Fits: TWL-TL016, TWL-TL033

Tech Tip

Twistlock Identification

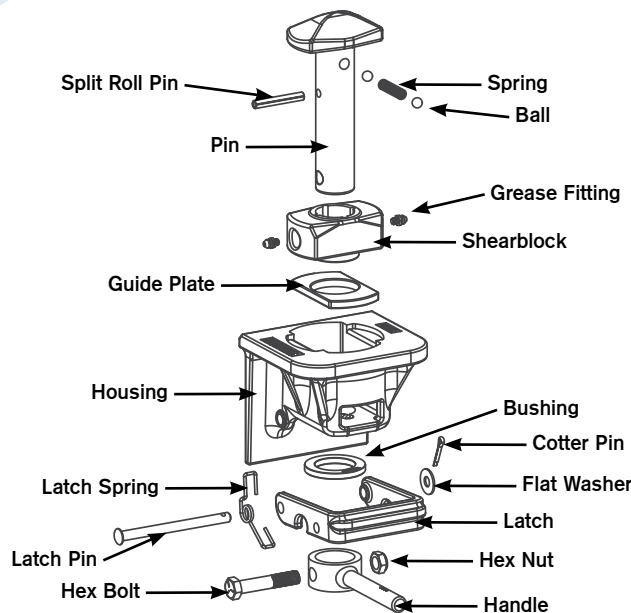

Security

SFT



Twistlocks

Latches

Safety
TWL-LA007

Pro-Fit

Material: Steel with Zinc Plate
Fits: TWL-PL004, TWL-PL006

Safety
TWL-LA010

Pro-Fit

Material: Steel with Zinc Plate
Fits: TWL-PL010, TWL-PL011

Safety
TWL-LA011

Pro-Fit

Material: Steel with Primer Finish
Fits: TWL-TL008, TWL-TL011

TWL-LA012

Pro-Fit

Material: Steel
Fits: PEN90-14

Retaining
TWL-LA013

Pro-Fit

Material: Ductile Iron with Primer Finish
Fits: TWL-PL008, TWL-PL018

TWL-LA019

Pro-Fit

Material: Steel
Fits: TWL-TL020, TWL-TL021, TWL-TL023, TWL-TL024, TWL-TL073

TWL-LA020
TWL-LA021

Pro-Fit

Material: Steel

TWL-LA023

Pro-Fit

Material: Steel with Zinc Plated
Fits: TWL-HA003, TWL-TL016, TWL-TL037

Security

SFT



Twistlocks

Latches

Tab
TWL-LA025

1-5/16 in.

1-1/2 in.

Pro-Fit

Material: Steel with Zinc Plated

TWL-LA026

1-1/32 in.

1-13/32 in.

5-11/16 in.

Pro-fit

Material: Steel

TWL-LA052

1 in.

4-5/8 in.

Pro-Fit

Material: Steel

TWL-LA053

2 in.

3-7/16 in.

Pro-Fit

Material: Steel
Fits: TWL-PL010, TWLPL011

Latches

TWL-LA065

3-1/4 in.

2-3/4 in.

Pro-Fit

Material: Galvanized Steel

Pins

TWL-PP001

1.00 in.

5-1/4 in.

Pro-Fit

Material: Steel
Fits: TWL-PL001, TWL-PL002, TWL-PL003

Pins

TWL-PP003

7-1/4 in.

1-1/2 in.

Pro-Fit

Material: Steel
Fits: TWL-HA022

TWL-PP007
TWL-PP004

Location
Left
Right

5-5/16 in.

1-1/2 in.

Pro-Fit

Material: Steel
Fits: TWL-PP004, TWL-PP007

Security

SFT



Twistlocks

Pins

	Location	
	Left	TWL-PP019
	Right	TWL-PP020

8-1/4 in.

1-1/2 in.

Pro-Fit

Material: Steel

7-9/16 in.

3-11/16 in.

Pro-Fit

Material: Steel with Primer Finish
Fits: Schulz F33NS-LP

7-13/32 in.

2-1/4 in.

Pro-Fit

Material: Steel with Primer Finish
Fits: TWL-HA003, TWL-LA023, TWL-TL008, TWL-TL011

5-7/16 in.

3-11/16 in.

Pro-Fit

Material: Steel

7-13/16 in.

3-3/4 in.

1-1/2 in.

Pro-Fit

Material: Ductile Iron with Primer Finish

5-1/8 in.

3-3/4 in.

1-1/2 in.

Pro-Fit

Material: Steel with Primer Finish

4-11/16 in.

3-11/16 in.

Pro-Fit

Material: Steel

5-1/8 in.

3-11/16 in.

1-1/2 in.

Pro-Fit

Material: Steel
Fits: TWL-DL001, TWL-DL002, TWL-TL071, TWL-TL072

Security

SFT



Security

658

800.621.7949

= Key Items

www.AuroraParts.com

Twistlocks

Pins

TWL-PT010

Pro-Fit

Material: Ductile Iron with Primer Finish
Fits: Penz 90-03

TWL-PT012

Pro-Fit

Material: Steel

TWL-PT013

Pro-Fit

Material: Steel
Fits: Westlake 85-2/3

TWL-PT042

Pro-Fit

Material: Steel

Additional Components

Detent Ball
TWL-HD003

Pro-Fit

Material: Chrome Alloy
Size: 11mm
Cross: Schulz 905-000-195

Detent Ball
TWL-HD006

Pro-Fit

Material: Steel
Size: 10mm

Spring
TWL-HD001

Pro-Fit

Material: Stainless Steel

Spring
TWL-HD004

Pro-Fit

Material: Spring Steel
Fits: 1102-1257, 1102-1259, 1102-3259

Security

SFT



Twistlocks

Additional Components

TWL-HD008

Material: Spring Steel

Pro-Fit

**Clevis Pin
TWL-HD002**

Pro-Fit

**Latch Pin
TWL-HD007**

Fits: 3133, 3187, 3189, 3190, 3533-90

Pro-Fit

**Split Roll Pin
TWL-HD012**

Material:
Fits: 1129, 3133, 3190, 3523, 3590

Pro-Fit

**Guide Plate
TWL-HD005**

Non-Screwdown Only
Fits: 3500, 3600, 3700

Pro-Fit

**Guide Plate
TWL-HD031**

For Pinlock House

Pro-Fit

More Information

www.MyAuroraPlus.com

Twistlock & Pinlock Components

Need more information on a particular twistlock? Log into www.MyAuroraPlus.com for Aurora's Graphical Bill of Material (GBOM). Easily point and click through our twistlocks to drill down to an individual assembly or component.



Security

SFT



Coil Racks

Type
Standard **KIN8656**
Heavy Duty **KIN80044**



Material: Steel
Size: 33-1/4 in. x 2-3/4 in. x 2-7/8 in.

Light Duty
CRG-LDCOIL



Material: Steel

Coil Mat
CRG-COILMAT



Material: Rubber
Size: 5 in. x 48 in.

Coil Felt Pad
CRG-FELTPAD



Material: Felt
Size: 8 in. x 12 in. x 1/4 in.

Coil Timber
WDS5-1



Bevel Edge
Size: 48 in. x 4 in. x 4 in.

Kinedyne

Accessories



SFT



Decals

Fire Extinguisher Inside
DEC1-5



Pro-Par

Color: White
Size: 3-11/16 in. x 11 in.

Pro-Par Logo
DEC1-21



Annual Vehicle Inspection

Type
Aluminum Label w/ Punch Boxes **JJK54-SN**
Clear Overlay **JJK2402**



J.J. Keller

Fire Extinguisher Inside
LABMPDFL1000



Label Master

Bright, bold lettering is printed with fade-resistant UV inks on exterior grade vinyl with permanent adhesive backing; Measures 1-3/4 in. x 10 in.

ABS Sticker
PET2954



Peterson

Size: 4 in. x 1-1/4 in.

Wabash Logo
WAB25000010



Wabash

Size: 8 in. x 10 in.

ABS Sticker
WAB25000719



Wabash

Size: 2-3/4 in. x 1-1/8 in.

J.J. Keller & Associates, Inc. Since 1953

LABELMASTER

Accessories

SFT

WABASH

Decals

Replacement DOT WAB25000869

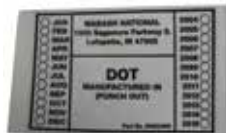

Warning: This decal is to be used on Wabash National or Fruehauf brand trailers built after January 25th, 1998. It is not to be used on any other manufacturer's trailers or bumpers. It is only to be used as a replacement for an original bumper decal that has been damaged. It may only be applied to original bumpers that have been repaired or replaced to original manufacturer condition.

California Legal Real Axle Location WAB25000874



2-1/2 in. x 4 in.

Wide Turn

Part Number	Height	Width
DEC1-2		
LABRT-14	10-1/2 in.	13-1/4 in.
LABRT-18	14 in.	18 in.
SAFSB-STK-401		8 in.



(DEC1-2)



(LABRT-14 / LABRT-18)



(SAFSB-STK-401)

Document Holders

Certificate Holder

	Diameter	Height	Color
IMXGT-1001	5 in.	1-43/64 in.	Gray
IMXGT-1007	5 in.	2 in.	Gray
TRU97960	5-7/32 in.	2-5/32 in.	Gray
FLT022-01175	5-1/4 in.		Gray
OPTDH55	5-1/2 in.	2-1/8 in.	Gray
OPTDH55Y	5-1/2 in.	2-1/8 in.	Yellow
BETPS1			Gray
PHI16-802			Gray
GRT43901	6-1/2 in.	1-11/16 in.	Gray

Replacement Parts

Replacement Lid & Seal:	IMXGT-1004
Replacement Lid:	IMXGT-1008
Replacement Lid:	TRU97962
Replacement Lid:	FLT022-01180
Replacement Lid:	BETPS71
Replacement Lid:	PHI16-801
Replacement Lid:	GRT93351



(IMXGT-1001)



(IMXGT-1007)



(TRU97960)



(FLT022-01175)



(OPTDH55)



(BETPS1)



(PHI16-802)



(GRT43901)



Accessories

Document Holders

Manifest Box

	Width	Height	Length	Material	Color
IMXGT-1002A	8 in.	1-1/2 in.	13 in.	Aluminum	
IMXGT-1002WHT	8 in.	1-1/2 in.	13 in.	Aluminum	White
PEN10-01	8-3/8 in.	1-1/2 in.	13-3/8 in.	Aluminum	



Replacement Parts

Clip: **PEN10-01-D**

Record Box

	Width	Height	Length	Lid
IMXGT-1055	10 in.	1-1/4 in.	15 in.	Flip
JKG550	10 in.	1-1/4 in.	15 in.	Flip
IMXGT-1050	11-1/2 in.	1-1/2 in.	16 in.	Side
JKG500	11-1/2 in.	1-1/2 in.	16 in.	Side



Replacement Lid

JKGJK500LID-ONLY

Security Box

	Width	Height	Length	Additional
JKG300	5-1/4 in.	2 in.	7 in.	
IMXGT-1006A	5-1/4 in.	2 in.	7 in.	
JKG350	5-1/4 in.	2 in.	7 in.	Xenoy
IMXGT-1035	5-1/4 in.	2 in.	7 in.	Xenoy



Replacement Lid

JKG300-LID
IMXGT-1009
JKG350-LID

Tube Box

	Diameter	Length
IMXGT-1003	1-1/2 in.	9 in.
TIS158-CK		



Replacement Lid

IMXGT-1005
TIS158-E

Accessories

SFT

XING

Document Holders

Flexi 2-V Document Holder
FLC2-V



Permit Holder
GRT43411



Registration Holder
JJK1RSP-DD



Fenders

Aluminum Fenders

Rear

	Length
FRUTKA9275	93 in.
FRUTKA9275-1	99 in.
FRUTKA9275-2	112 in.
FRUTKA9275-5	142 in.

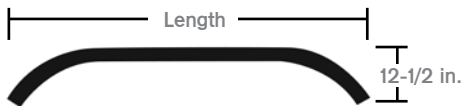

Front

	Length
FRUTKA9281-1	135 in.
FRUTKA9281-2	145 in.
FRUTKA9281-6	175 in.

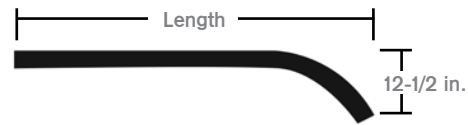

Full Round

Spray Mate Polypropylene, Black

	Info
FLT034-01520	Single Fender
FLT031-01520	Pair of Fenders (2) FLT034-01520

Lightweight, high density polypropylene material; fade resistance; unaffected by heat & cold; support straps on the underside of the fender



Fleet Engineers

Accessories



SFT



Fenders

Quarter Fenders

Air Slipper

	Color
FLT031-00400	Black
FLT031-00402	Stainless Steel



Smooth surface with large radiused side flanges; heavy-duty reinforcement plate supports from the underside; universal fitting; pre-assembled for speedy installation; kit includes: 1-right & 1-left fender assembly with hanger clamps & hardware

Fleet Engineers

Air Slipper Two

	Location	Includes
FLT031-00406		(1) Roadside Fender, (1) Curbside Fender, Hanger Clamps & Hardware
FLT034-00731	Roadside	
FLT034-00732	Curbside	

One-piece injection molded; 25 in. width increases tire coverage & greatly reduces spray, stones & other deflections; unaffected by heat & cold



Fleet Engineers

Standard FLT031-01070



Fleet Engineers

Flattened tube design requires no cradle or braces; hidden mounting bolts; reinforcement strap on underside of fender; package set includes one right & one left fender with hanger clamps & hardware plus white top flaps & top flap hardware; pre-assembled for speedy installation; Stainless Steel

High Performance JKG1900KIT



James King

Braceless design; curved surfaces to hold spray & stones to a minimum; guaranteed not to chip, crack, or break; Black; set with top flap

Fenders

Accessories

U Bolt Mounting Kit FLL1715-11MM



Post Mount Socket

Includes	Type	
2-Post Mount Sockets	Kit	FLT031-00235
	Individual Socket	FLT032-00199



Spray Mate Mount Support FLT031-00823



Spray Mate End Mount FLT031-01250

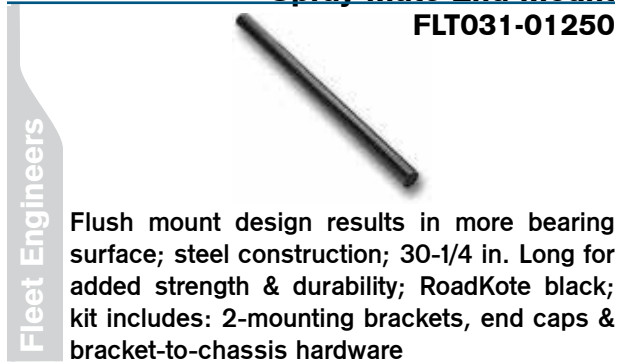

Quarter Fender Top Flap

	Color	Material	Width	Height	Type
FLT031-00242	Black	Rubber	24 in.	6 in.	Kit: (2) flaps, (8) nuts, (8) bolts, (8) washers
FLT033-00430	Black	Poly	24 in.	5 in.	Kit: (2) flaps, (8) nuts, (8) bolts, (8) washers
IMXGT-2406	Black	Rubber	24 in.	6 in.	
IMXGT-2406PSB	Black	Poly	24 in.	6 in.	
IMXGT-2406PSW	White	Poly	24 in.	6 in.	



More Information

www.MyAuroraPlus.com

Need more information on a particular trailer? Log into www.MyAuroraPlus.com for Aurora's Graphical Bill of Material (GBOM). Easily point and click through visual elements of a trailer to drill down to an individual trailer part.

Log Books

JJK2PLYCARBON-12B



Duplicate

Annual Vehicle Inspection Report

JJK200-FS-C3



3-ply, with carbon; snap-out format
Complies with DOT \$396.21

Vehicle Inspection

JJKWW-400-FS-C3



3-ply, Carbonless

DOT Inspection Tag

JJK49-SN



Material: Vinyl w/ Mylar Laminate
Size: 5 in. x 4 in.

Mirrors

Round Convex

	Diameter	Color	Mounting	"L" Bracket
TRU97815	7-1/2 in.	Stainless Steel	5/16 in. Female Stud	Included
TRU97814	8-1/2 in.	Stainless Steel	Offset 5/16 in. Female Stud	Included
TRU97804	8-1/2 in.	Black	5/16 in. Female Stud	Included
TRU97803	8-1/2 in.	Stainless Steel	5/16 in. Female Stud	Included



(TRU97815/
TRU97803)



(TRU97814)



(TRU97804)

Truck-Lite

Quick Reference

Mudflap Mounting Kits

Part Number	Size
BESB516P	Single Kit
IMXGT-27516BUCKET	50 Kits

Kit Includes:

4 Bolts, 4 Lock Washers, 4 Nuts & 8 Flat Washers

Mudflaps

Plastic

Wide Turn

	Type	Color	Thickness	Width	Height
SPL99-12	Straight	Yellow	3/16 in.	24 in.	19 in.
SPL99-13	Straight	Yellow	3/16 in.	24 in.	24 in.
SPL99-10	Right Hand Angle	Yellow	3/16 in.	24 in.	24 in.
SPL99-9	Left Hand Angle	Yellow	3/16 in.	24 in.	24 in.
SPL99-17	Straight	Yellow	3/16 in.	24 in.	27 in.
SPL99-18	Two Side Angle	Yellow	3/16 in.	24 in.	27 in.
SPL99-45	Straight	Yellow	3/16 in.	24 in.	29 in.
SPL99-11	Straight	Yellow	3/16 in.	24 in.	30 in.
SPL99-8	Straight	Yellow	3/16 in.	24 in.	36 in.



(SPL99-12/
SPL99-13/
SPL99-17/
SPL99-45/
SPL99-8)



(SPL99-10)



(SPL99-9)



(SPL99-18)

Wabash Logo

	Type	Color	Thickness	Width	Height
SPL2-3	Straight	Black	1/4 in.	24 in.	30 in.
SPL2-5	Straight	Black	5/16 in.	24 in.	30 in.



Polyguard

Anti-Spray Heavy Duty

	Type	Color	Thickness	Width	Height
IMXGT-2424PHDB	Straight	Black	3/8 in.	24 in.	24 in.
IMXGT-2424PHDW	Straight	White	3/8 in.	24 in.	24 in.
IMXGT-2430PHDB	Straight	Black	3/8 in.	24 in.	30 in.
IMXGT-2430PHDW	Straight	White	3/8 in.	24 in.	30 in.
IMXGT-2436PHDB	Straight	Black	3/8 in.	24 in.	36 in.
IMXGT-2436PHDW	Straight	White	3/8 in.	24 in.	36 in.



Channeled back reduces spray; special combo of polymers prevents sail, curling & cracking

Accessories

SFT

Mudflaps

Polyguard

Anti-Spray Medium

	Type	Color	Thickness	Width	Height	Notes
IMXGT-2418PPSW	Straight	White	1/4 in.	24 in.	18 in.	
IMXGT-2424PPSBLAC	Left Angle	Black	1/4 in.	24 in.	24 in.	
IMXGT-2424PPSBRAC	Right Angle	Black	1/4 in.	24 in.	24 in.	
IMXGT-2424PPSB	Straight	Black	1/4 in.	24 in.	24 in.	
IMXGT-2424PPSW	Straight	White	1/4 in.	24 in.	24 in.	
IMXGT-2427PPSB	Straight	Black	1/4 in.	24 in.	27 in.	
IMXGT-2427PPSW	Straight	White	1/4 in.	24 in.	27 in.	
IMXGT-2428PPSBS	Straight	Black	1/4 in.	24 in.	28 in.	with Hole
IMXGT-2428PPSW	Straight	White	1/4 in.	24 in.	28 in.	
IMXGT-2430PPSB	Straight	Black	1/4 in.	24 in.	30 in.	
IMXGT-2430PPSW	Straight	White	1/4 in.	24 in.	30 in.	
IMXGT-2436PPSB	Straight	Black	1/4 in.	24 in.	36 in.	
IMXGT-2436PPSW	Straight	White	1/4 in.	24 in.	36 in.	

Channeled back reduces spray; special combo of polymers prevents sail, curling & cracking



Standard

	Type	Color	Thickness	Width	Height
IMXGT-2424PSB	Straight	Black	3/16 in.	24 in.	24 in.
IMXGT-2424PSW	Straight	White	3/16 in.	24 in.	24 in.
IMXGT-2430PSB	Straight	Black	3/16 in.	24 in.	30 in.
IMXGT-2430PSW	Straight	White	3/16 in.	24 in.	30 in.
IMXGT-2436PSB	Straight	Black	3/16 in.	24 in.	36 in.
IMXGT-2436PSW	Straight	White	3/16 in.	24 in.	36 in.

Economic; special combo of polymers prevent sail, curling & cracking



Standard With Etching & Hole

Height	Width	Part Number
24 in.	24 in.	SPL99-72NOLOGO
30 in.	24 in.	SPL99-70NOLOGO



Tireplast Heavy-Duty

Height	Width	Thickness	Part Number
30 in.	24 in.	1/4 in.	IMXGT-2430TPPSB
30 in.	24 in.	3/8 in.	IMXGT-2430TPHDB



Thermo plastic rubber; anit-curling attributes of a rubber flap; stiff anti-sail features of a poly flap; ribbed back for anti-spray; Black

Accessories

SFT

Mudflaps

Rubber

Anti-Spray Heavy Duty

	Type	Color	Thickness	Width	Height
IMXGT-2424HD	Straight	Black	1/2 in.	24 in.	24 in.
IMXGT-2430HD	Straight	Black	1/2 in.	24 in.	30 in.
IMXGT-2436HD	Straight	Black	1/2 in.	24 in.	36 in.



Fiber reinforced rubber; raised knobs on back for anti-spray

Anti-Spray Quick Change

Height	Width	Thickness	Color	
30 in.	24 in.	1 in.	Black	SPL5-3



All-rubber mudflap that features the easy two-step quick changeability plus finger-like projections directing spray downward while the built-in side ridges prevent lateral spary

Anti-Spray Safety

Height	Width	Thickness	Color	
30 in.	24 in.	1/2 in.	Black	KON082430C
36 in.	24 in.	1/2 in.	Black	KON082436C



Ultra rubber, tough anti-spray & anti-sail performance; finger-like projections keep spray & stones to a minimum

Chevron

	Type	Color	Thickness	Width	Height
IMXGT-2424CD	Straight	Black	1/4 in.	24 in.	24 in.
IMXGT-2430CD	 Straight	Black	1/4 in.	24 in.	30 in.
IMXGT-2436CD	Straight	Black	1/4 in.	24 in.	36 in.



100% fiber reinforced rubber; economy style flap; equipped with mounting holes for angle bracket

Standard

	Type	Color	Thickness	Width	Height
IMXGT-2418S	Straight	Black	5/16 in.	24 in.	18 in.
IMXGT-1924S	Straight	Black	5/16 in.	19 in.	24 in.
IMXGT-2424S	Straight	Black	5/16 in.	24 in.	24 in.
IMXGT-2430S	Straight	Black	5/16 in.	24 in.	30 in.
IMXGT-2436S	Straight	Black	5/16 in.	24 in.	36 in.



Bordered edge gives clean look; preferred flap for custom logos; fiber reinforced rubber

Accessories

SFT

Mudflaps

Rubber

Fruehauf Logo

Height	Width	Thickness	Color	
42 in.	24 in.	1 in.	Black	SPL1-26



High Tensile Strength

	Type	Color	Thickness	Width	Height
IMXGT-2424X	Straight	Black	3/8 in.	24 in.	24 in.
IMXGT-2430X	Straight	Black	3/8 in.	24 in.	30 in.
IMXGT-2436X	Straight	Black	3/8 in.	24 in.	36 in.
IMXGT-2440X	Straight	Black	3/8 in.	24 in.	40 in.
IMXGT-2442X	Straight	Black	3/8 in.	24 in.	42 in.



Molded from high tensile strength rubber; triple layer strength; stiffer flap prevents waving; equipped with mounting holes for angle bracket

More Information

Custom Mudflaps

Guidelines

- 200 each minimum order
- There is an artwork charge for each sample that will have a proof made. Order must be placed within a 2 week period.
- There will be a one time setup fee for each order.
- Lead time is approximately 4-6 weeks upon receipt of order & signed approval of mudflap.

Polyguard Flaps		
Hot Stamp Colors	Flap	Imprint
Red (P 187)		
Blue (P 286)		
Dark Blue (P 282)		
Light Blue (P 299)		
Dark Green (P 350)		
Yellow (P 123)		
Orange (P 166)		
Burgundy (P 188)		
Green (P 349)		
Dark Brown (P 497C)		
Brown (P 4635)		
Teal (P 322)		
Gray (P Cool Gray 9 C)		
Silver (P 877C)		
Gold (P 871C)		
Tan (P 4655C)		
Black		
White		
Custom Colors Available		

Ordering

To order custom mudflaps, please call us at 800-621-7949 with the following information:

Flap Type _____

Flap Size _____

Order Quantity _____

Rubber Flaps		
Silkscreen Colors	Flap Color	Imprint
Red (Pantone 185 C)	N/A	
Blue (Pantone 2945 C)	N/A	
Yellow (Pantone 115 C)	N/A	
Green (Pantone 3298 C)	N/A	
Orange (Pantone 1655 C)	N/A	
Gray (P Cool Gray 5 C)	N/A	
Black		N/A
White	N/A	

Mudflap Brackets

Bar

Straight

	Type	Bar Size	Includes
BESB23	Standard Kit	0.640	(2) Brackets + (2) Mounting Brackets BETB-711 + Adjustable Clips + (2) Cotter Pin + Mounting Hardware
BESB25	Standard Kit	0.640	(2) Brackets + (2) Mounting Brackets BETB-711 + Adjustable Clips + (2) Cotter Pin + Mounting Hardware
BESA25RL	Display	0.640	(40) Brackets & (1) Small Betts Barrel
BESA25RLB-40	Bulk	0.640	(40) Brackets



(BESB-23)



(BESB-25)



(BESA25RL)

BettsHD

Angled

	Type	Includes
BESB33	Standard Kit	(2) Brackets + (2) Mounting Bracket BETB-711 + Adjustable Clips + (2) Cotter Pin + Mounting Hardware
BESB35	Standard Kit	(2) Brackets + (2) Mounting Bracket BETB-711 + Adjustable Clips + (2) Cotter Pin + Mounting Hardware
BESA35RL	Display	(40) Brackets + (1) Small Betts Barrel
BESA35RLB-40	Bulk	(40) Brackets
BESA81RL	Extra Heavy Duty	



(BESB33)



(BESB35)



(BESA35RL)

BettsHD

Fleet Engineers

	Type	Additional Info
FLT034-00426	Bracket	Straight
FLT031-00125	Bracket Set	Right Angle; Includes Two Arms, Mounting Sockets & Mounting Hardware

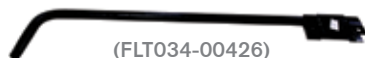

(FLT034-00426)

Fleet Engineers

Spring Loaded

Fleet Engineers Straight

	Color	Includes	Additional
FLT033-00270	Black	End Caps + Mounting Hardware + (2) Brackets	
FLT033-00868	Black	End Caps + Mounting Hardware + (2) Brackets	Heavy Duty



(FLT033-00270)



(FLT033-00868)

Fleet Engineers



ELIMINATE MUD FLAP LOSS



Our trailer mud flap retention system features innovative spring steel mounting brackets, coupled with either our DirectFlex® mud flap hangers or our spring loaded mud flap hangers.

It's easy to install and virtually eliminates mud flap loss - it's the ideal way to ensure safe and legal operation while on the road.

- ✓ **Reduce CSA Violations**
aka Mud Flap Missing (392.2WC)
- ✓ **No More Cutting & Welding**
Makes Roadside & Driver Repair Possible
- ✓ **Lower Costs**
Minimize Downtime & Repairs



Can you afford *NOT* to try it?
877-843-5195

Visit BettsHD.com
for our full line of heavy duty spray
suppression and conspicuity products

Mudflap Brackets

Spring Loaded

Hellcat® Straight

	Conspicuity Tape	Type	Includes
FLT033-04993	Yes	Kit	(2) Brackets + Reflectors + Mounting Hardware + End Caps + Plastic Snap Rivets + Plugs



Fleet Engineers

Betts Straight

	Conspicuity Tape	Type	Includes
BESB573025NTBK	No	Kit	(2) Brackets + (4) Stud Nuts + Mounting Hardware
BESB573025WTBK	Yes	Kit	(2) Brackets + (4) Stud Nuts + Mounting Hardware



(BETB573025NTBK)

(BETB573025WTBK)

Betts

Betts Tapered

	Conspicuity Tape	Type	Includes
BESB703000RTSK	Yes	Kit	(2) Brackets + (2) BESRT25RL Conspicuity Strips + (4) Stud Nuts + Mounting Hardware



Betts

Betts Angle

	Conspicuity Tape	Type	Includes
BESB673025NTBK	No	Kit	(2) Brackets + (4) Stud Nuts + Mounting Hardware
BESB673025WTBK	Yes	Kit	(2) Brackets + (4) Stud Nuts + Mounting Hardware



(BETB67025NTBK)

(BETB67025WTBK)

Betts

Fleet Engineers Angle

	Color	Includes
FLT033-00864	Black	(2) Brackets + Mounting Hardware + End Caps



(FLT033-00864)

Fleet Engineers

Accessories

FLEET ENGINEERS

SFT

BettsHD

Mudflap Brackets

Fixed

Bolting Plate
BUF2002-2866



Material: Steel
Size: 27-1/2 in. x 2-1/4 in.

Mounting Angle

Info	
Mounting Angle	FLT033-00051
Retaining Strap for FLT033-00051	FLT033-00053



(FLT033-00051)

1/8 in. Thick, heavy-duty steel construction; black primer finish; 2 in. X 2 in. x 27-1/2 in.

Mudflap Bracket
IMXGT-3000



30 in.; 10 Gauge

Mudflap Bracket
PEN07-50



27-1/2 in. X 2-1/8 in.

Flap Bracket
FRUFCF6215-1



Length: 26-3/4 in.

Quick Change Mounting Bracket
FRUJNE0536-1



Provides easy-on, easy-off convenience for Nyracord quick change mudflaps; 24-1/4 in.

Flap Bracket

Size	
4 in.	WAB02600005
6-1/2 in.	WAB02600196

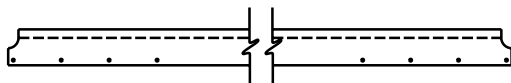

Length: 100 in.

Flap Retainer

Includes	Type	
-	Bracket	WAB02600007
(1) Bracket + (4) Locknuts + (4) Carriage Bolts	Kit	SPLMFAHWFLAP



2 in. x 22-1/2 in.

BUFFERS USA

FLEET ENGINEERS

SFT

WABASH

Accessories

Mudflap Brackets

Fixed

Flap Bracket

Location	
Roadside	WAB02600050
Curbside	WAB02600051



Length: 30 in.

Flap Bracket

WAB02600724



Bolt On
Length: 100 in.

Accessories

Standard Mounting Bracket

	Type	Hole Centers	Includes
BESB711	Bracket	1-7/8 in.	
BESK711	Kit	1-7/8 in.	(2) Brackets + Mounting Hardware
BESB1732	Bracket	2-7/8 in.	
BESK1732	Kit	2-7/8 in.	(2) Brackets + Mounting Hardware

One-piece, cast steel, heavy duty mounting bracket; designed to fit all Betts standard mudflap hangers; same high quality finish as Betts hangers & painted to match

BettsHD



(BESB711)



(BESB1732)

Mounting Kit - Standard FLT031-00896

Fleet Engineers



Includes: (2) Brackets & Mounting Hardware

Conspicuity Top Mounted Mudflap

Type	
Straight	JKG2800
Angled	JKG2845

James King



(JKG2800)



(JKG2845)



Accessories

Mudflap Brackets

Accessories

Universal Conspicuity Plate

Type	
Straight	FLT033-04259
Shortie	FLT033-04263



(FLT033-04259)



(FLT033-04263)

Fleet Engineers

Aluminum; reflective tape attached

Conspicuity Reflector Set

Type	
Straight	BESRT25
Angled	BESRT35



(BESRT25)

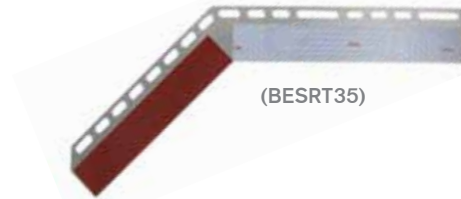

(BESRT35)

Betts

Standard Anti-Sail Bracket

Material	
Chrome	FLT033-00075
Galvanized	FLT033-00078
Steel Painted Black	FLT033-00079



Fleet Engineers

Steel construction, 5/16 in. diameter wire; 3/8 in. diameter mounting eyes; fits standard 24 in. wide mud flaps; accepts mud flaps up to 1 in. thick

Flap Mounting Bolt Kit

Count	
Single Kit	BESB516P
50 Kits	IMXGT-27516BUCKET



(IMXGT-27516BUCKET)



(BETB-516)

- Kit Includes: 4 Bolts, 4 Lock Washers, 4 Nuts & 8 Flat Washers

Tire Carriers

**Binkley Style
PRO-TC3**



Pro-Par

Mounting Hardware Not Included
Hardware Kit: HOLCP3473

**Basket Type
PRO-TC4**



Pro-Par

Accessories

Mounting Kit
PRO-TC4-HDW

**Mounting Kit
PRO-TC4-HDW**

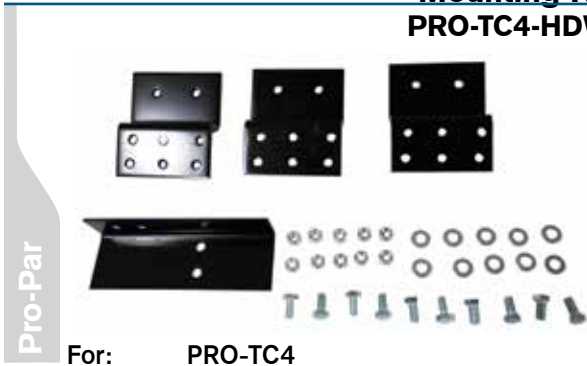

Pro-Par

For: PRO-TC4

**Binkley Style
UNFTC3**



Vents

**Dry Freight
FLT024-02501**



Fleet Engineers

Double seal foamed door; one piece anodized aluminum frame for strength & easy installation; anti-intrusion screen for security, also allows more air flow; 17 in. x 11-3/8 in., White

**Louvered Vent
IMXGT-1105**



Slide by vent; 10-1/2 in. X 12 in.; Aluminum

**Double Seal Rigid
PENP-1052S-SBHW-S**



Penz

Stainless steel; bottom hinged; aluminum safety screen; 2# density rigid polyurethane foam; refrigerated trailer vent; outside size: 5-1/4 in. X 19-1/8in.

PENP-1076ALUMBH



Penz

All aluminum construction with stainless steel hardware; bottom hinged; waterproof construction; aluminum safety screen; 6-3/4 in. x 17-1/4 in., Mill Finish

Accessories



SFT



Accessories



Penz

PRODUCTS, INC.

SERVING THE TRUCK TRAILER AND CONTAINER INDUSTRY
FOR OVER 60 YEARS

(574) 255-4736 1320 S. Merrifield Ave Mishawaka, Indiana 46544



Vents

PENP-1077WHTBHW-S



Penz

All aluminum construction with stainless steel hardware; bottom hinged; waterproof construction; aluminum safety screen; 11-1/2 in. x 17-1/4 in., White

**Double Seal Flexible
PENP-2200SS-SCR-HL**



Penz

2# density flexible polyurethane foam; refrigerated trailer vent; side hinge; stainless steel; 7-1/2 in. x 20 in.; screen included

Accessories

Door Plunger & Socket

Type	
Female	IMXGT-1309
Male	IMXGT-1310



(IMXGT-1309)



(IMXGT-1310)

Material: Rubber
Hansen #38-R mated

Vent Door Plunger & Socket

Size	Type	
1-5/8 in.	Socket	IMXGT-1315
	Plunger	IMXGT-1308



(IMXGT-1315)



(IMXGT-1308)

Material: Galvanized Steel

Vent Latch

	Type	Material
PEN10-1300S-S	Belly Box	Stainless Steel
PEN10-1300Z-P	Belly Box	Zinc Plated
PEN10-1500S-S		Stainless Steel
PEN10-1900S-S		Stainless Steel
PEN10-1900Z-P		Zinc Plated



(Belly Box)



(Standard)

Penz

**T-Handle Door Latch
BUYL8815**



Accessories

SFT

Penz

Wiper Blades

Arctic Winter

	Length
ANO30-18	18 in.
ANO30-20	20 in.
ANO30-22	22 in.
ANO30-24	24 in.



30 Series; connectors that fit standard industry saddle widths; protective rubber cover to prevent snow/ice buildup on blade structure joints; all-weather performance

Federal-Mogul

Metal Structure

	Length
ANO31-16	16 in.
ANO31-18	18 in.
ANO31-20	20 in.
ANO31-22	22 in.
ANO31-24	24 in.



31 Series; Kwik connect; vented all-steel structure for aerodynamic performance; world-class exterior black finish

Federal-Mogul

Universal

	Length
ANO91-16	16 in.
ANO91-20	20 in.
ANO91-22	22 in.
ANO91-24	24 in.



91 Series; Kwik connect; exclusive DuraKlear rubber delivers smooth water removal, excellent visibility, and long-lasting performance; wrap-around claw design gives superior aerodynamics

Federal-Mogul

Arctic Winter

	Length
WIP20-AR	20 in.
WIP22-AR	22 in.
WIP24-AR	24 in.



Rugged steel construction will not twist, warp or crack; fully enclosed wiper keeps out ice, sleet & snow; extra large rubber wiper covers more surface area; quick & easy installation

Old World Ind.

All Season

	Length
WIP18-AS	18 in.
WIP20-AS	20 in.
WIP22-AS	22 in.
WIP24-AS	24 in.



All metal frame construction; stainless steel spline; advanced rubber compound; high quality finish; quick & easy installation

Old World Ind.



Accessories

SFT

